



**Maxforce<sup>®</sup>**  
**LN**

**FOR USE ONLY AS AN  
INSECTICIDE**

**For use indoors and outdoors as  
an insecticidal bait.**



#### **Description**

Maxforce LN Ant Killer is an insecticidal bait for professional and amateur use against black ants for use in and around the home, for use within commercial and industrial premises, on lawns, in areas surrounding public swimming pools terraces, patios and pathways.

Maxforce LN bait consists of sugar and honey with a special bait matrix which attracts the ants which feed and distribute the bait throughout the colony. Ants die in their nests. Dead ants may not be seen at the treated spots. Physically affected ants may be seen after 3-4 days. Colony eradication can be expected within 7-14 days after treatment, depending on the size of the infestation.

#### **Field(s) of application:**

Maxforce LN Ant Killer is an insecticide for use against black ants and other ant species. The Pest Control Operator must carry out a risk assessment prior to use so that access of birds to the bait stations and ants carrying the bait is restricted. When used outdoors bait stations should be sited as close to the nest entrances as possible. This product must not be used where birds could gain access to it. When used around swimming pools the bait boxes should be placed in areas protected from splashes.

#### **Pest/ target:**

Black Garden ant (*Lasius niger*).

This product is approved under The Control of Pesticides Regulations 1986 (as amended) for use.

Emergency contact/phone No. 0800 220876.

Approval Holder: Bayer SAS, Lyon

Further information is available from:  
Bayer Environmental Science  
Bayer CropScience Limited  
230 Cambridge Science Park -  
Milton Road - Cambridge CB4 0WB  
Tel: 00 44 (0) 800 1214 9451  
[www.pestcontrol-expert.com](http://www.pestcontrol-expert.com)



**Bayer Environmental Science**  
A Business Operation of Bayer CropScience

Content :  
Imidacloprid 0.05%  
HSE 8622

**15 bait stations**

**Directions for use:****To avoid risks to man and the environment, comply with the instructions for use.**

General: Apply out of reach and sight of children and domestic animals. For maximum effectiveness the bait boxes with Maxforce LN Ant Killer must be placed on or near ant trails. Survey the area to be treated to identify sites of ant infestation e.g. by using bait traps. An effect on the ant population can be expected within 7 days when frequency of foragers will decline. An increase in ant activity may be seen as ants are attracted to feed on it after treatment.

Most nests are eliminated within 14 days. However, under some circumstances like very high ant numbers or re-invasion, total control may take up to 2 months.

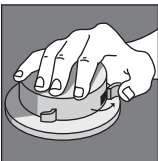
**How to open the bait station.**

Remove from sachet and snap off the 4 “hooks” to open the ant entry holes into the bait station. Do not take the bait station apart.

**Indoor use:**

Place bait station in a horizontal position where ants can be seen foraging for food. Indoors, trails are often emerging from underneath doors, windows or crack & crevices. Place one bait station per trail. In difficult situations (more than one trail) use additional bait stations.

**Outdoor use:**

Place bait stations in a horizontal position where ants can be seen foraging for food and where the bait station is protected from direct sun light and rain. Place one bait station per trail. In difficult situations (more than one trail) use additional bait stations.

**Dose rate(s)**

Apply one to four stations per nest. Place bait stations next to nests where ants forage so that bait can be taken back to the nest.

General ant control: Apply one to four bait stations per 5 square metres.

**STATUTORY CONDITIONS RELATING TO USE:  
FOR USE ONLY AS AN INSECTICIDE**

FOR USE BY PROFESSIONAL OPERATORS AND AMATEUR USERS

**Application Rate:**

Apply one to four stations per nest. Place bait stations next to nests where ants forage so that bait can be taken back to the nest.

General ant control: Apply one to four bait stations per 5 square metres.

The (COSHH) Control of Substances Hazardous to Health Regulations 2002 may apply to the use of this product at work.

Keep out of the reach of children.

When using do not eat, drink or smoke.

DO NOT USE where food, feed or water could become contaminated.

PREVENT ACCESS TO BAITS by children and animals.

REMOVE ALL REMAINS OF BAIT and bait containers.

HAZARDOUS TO BEES.

KEEP IN A SAFE PLACE.

WASH HANDS AND EXPOSED SKIN before meals and after use.

This product contains substances which are known to be hazardous to the environment.

Do not contaminate ground, waterbodies or watercourses with chemicals or used container.

This material and its container must be disposed of in a safe way.

**READ ALL PRECAUTIONS BEFORE USE (HSE No: 8622)**